

National Institute of Plant Genome Research
Aruna Asaf Ali Marg, Near ICSSR, JNU Campus, New Delhi – 110067
Phone: 26735161, 26735138 Fax: 26741658

F. No. NIPGR/7/55(1) /

Dated: 09.10.2013

NOTICE INVITING QUOTATIONS

Sealed item rate quotations are invited on behalf of the Director, NIPGR, New Delhi, from approved & eligible contractors in respect of the following work, so as to reach his office on or before 22.10.2013 up to 3.00 P.M. The quotation shall be opened on the same day at 3.30 P.M. in presence of the intending quotationers.

SCHEDULE OF QUANTITY

Name of Work: Construction of Net House in developing field at NIPGR Campus, New Delhi.

Sl. No.	Description	Qty.	UNIT	Rate (in Rs.)	Amount (in Rs.)
	As per enclosed Schedule of Quantity and Terms & Conditions				

Encl.: 1. Schedule of quantity.
2. Terms & conditions.

Administrative Officer
NIPGR, New Delhi



M/s _____

Seal & Signature of Contractor

Schedule of Quantity

Name of Work : Construction of Net House in developing field at NIPGR Campus, New Delhi

Sl. No.	Description	Unit	Qty.	Rate	Amount
1	Earth work in excavation in foundation trenches or drains (not exceeding 1.5m in width or 10 sq.m on plan) including dressing of sides and ramming of bottoms, lift upto 1.5m, including getting out the excavated soil and disposal of surplus excavated soil to lead upto 250m and lift upto 1.5m, excavated area to be levelled and neatly dressed.				
	a)All kinds of soil	Cum	9		
	b)Ordinary rock	Cum	6		
2	Cement concrete for the following specified mix using graded stone aggregate of 20mm maximum size including machine mixing, transporting, placing in position consolidation, finishing, curing etc. in all works upto plinth level complete as per specifications as directed. Complete as per instruction of Engineer-in-charge.				
	a) C.C 1:4:8(1 cement: 4coarse sand: 8graded stone aggregate 20mm nominal size)	Cum	3		
3	Brick work with bricks of class designation 75 in Cement Mortar 1:6(1 cement: 6 Coarse sand) to correct line, level and Plumb scaffolding including raking out joints/ simultaneous flush pointing with cement mortar 1:6, curing etc. complete upto plinth. as per specifications. Complete as per instruction of Engineer-in-charge.				
	Brick work of class designation 75 in foundation and plinth in :				
	a)Cement mortar 1:6 (1 cement : 6 coarse sand)	Cum	12		
4	Providing and laying in position cement concrete of specified grade excluding the cost of centring and shuttering - All work upto plinth level				
	a)1:2:4 (1 Cement : 2 Coarse sand : 4 Graded stone aggregate 20mm nominal size)	Cum	4		
5	Centering & shuttering including strutting propping, etc., and removal of form for				
	a)Column, pillars, piers, Abutment, etc.	sqm	21		
6	Before commencement of plastering the area shall be very closely hacked, cleaned, wetted and shall be marked with 'Thiyyas' or 'Tapanis' and shall be got approved by the Engineer-in-charge with no extra cost to depts.				
	6a) 12 mm cement plaster of mix :				
	1:6 (1 cement : 6Coarse sand)	sqm	45		
7	Steel work using structural steel such as built-up sections/framed work , angles(50mmx50mmx6mm), making 10mm dia holes at every 450mm interval including cutting, bolting and /or welding,erecting in position, and applying a coat of red oxide zinc chromate primer complete all as per drawings & specifications, and similar work as directed by the Engineer-in-charge.	Kg	500		
8	Supply & fixing Plain G.I. wire of approved thickness to make grids in field through angles as per site requirements and as directed by the Engineer-in-charge.	kg	75		
9	Painting of structural steels angles, flats etc. with synthetic enamel paint of approved brand and manufacture to give an even shade two or more coats on new work and as directed by the Engineer-in-charge.	sqm	20		
10	Providing & Fixing of MS Gate of frame size of Angle 65mmx65mmx6mm angle with 50mmx50mmx6mm angle and MS rounded bars of 12mm dia and 50mmx6mm flat in middle with locking arrangement with a MS aldrop inside & out Side, Heavy Class Hinges as per drawing complete as per instruction of Engineer -in-charge. Size of Gate --7ft(Ht.)x5ft(W)(In two panels)	Each	1		
11	Supplying and stacking of good earth at site including royalty and carriage up to site (earth measured in stacks will be reduced by 20% for payment). Spreading at designated site as directed by the Engineer-in-charge.	Cum	30		

12	Supplying and stacking manure(Cow dung) at site including royalty and carriage up to site (sludge measured in stacks will be reduced by 8% for payments) and spreading at designated site as directed by the Engineer-in-charge.	Cum	3		
		Total Amount			
(In words ₹-----)					

Seal & Signature of Contractor

Administrative Officer
NIPGR New Delhi

TERMS & CONDITIONS

Name of Work: Construction of Net House in developing field at NIPGR Campus, New Delhi.

1. The contractor should visit the site and make himself acquainted with the location .The Department shall entertain no extra claim later on.
2. The site of work is at NIPGR Campus, Aruna asaf Ali Marg New Delhi-110067.
3. The contractor shall make his own arrangement for the safe custody of material at site.
4. The contractor shall arrange all T&P; scaffolding arrangement to access the work locations and nothing will be extra paid.
5. Contractor should be responsible for all safety precaution at work.
6. The contractor must get the **prior approval of materials** from the Engineer- In - Charge.
7. The rates shall be inclusive of Transportation, loading, unloading and handling charges and nothing extra will be paid.
8. The rates shall be inclusive of all taxes including VAT & Service tax and nothing extra will be paid.
The rates shall be finished items of work
9. The contractor shall follow all labour laws as prevailing in Delhi.
10. All works shall be completed as per drawing and the entire satisfaction of the Engineer-in-charge.
11. The Director reserves the right to reject / accept any or all quotation without assigning any reason.
12. In case of any dispute the decision of the Engineer-in-charge shall be final & binding on the contractor.
13. Any work not carried out as per instruction of the Engineer-in-charge shall be dismantled and reconstructed by the contractor without any extra cost.
14. The work shall be completed in all respects within **One month** from the date of issue of work order. Being time bound, contract, and the contractor shall be liable to pay compensation @1. % per per day subject to maximum 10% of W.O. amount if the work is not completed within stipulated time of Completion.
15. The agency must be expertise, experienced in the construction of civil works.
16. The Contractor shall be responsible for any damages and site clearance and nothing extra will be paid. In case the site clearance and damages are not attended, a recovery amounting to ₹10,000/- (₹. Ten thousand only) shall be made.
17. The quotation must be accompanied with EMD of ₹.3020 (₹. Three thousand & Thirty two only). The earnest money (EMD) shall be in the form of DD of scheduled bank drawn in favour of **"Director NIPGR" New Delhi. Without EMD quotation shall not be considered.**
18. The **EMD shall be enclosed in a separate envelop duly marked EMD which shall be opened first.**

19. Security deposit @ 10% shall be deducted from the bill and shall be refunded after the completion of defect liability period of **Six Months**. The EMD will however be adjusted towards security deposit. . The **EMD shall be enclosed in a separate envelop duly marked EMD which shall be opened first.**
20. All papers attached with this Quotation should be signed & returned in original.

PAN No.-----

**Administrative Officer
NIPGR**

TIN No. -----

Seal & Sign Of Contractor

PLAN VIEW OF FIELD (Dr.Naveen)

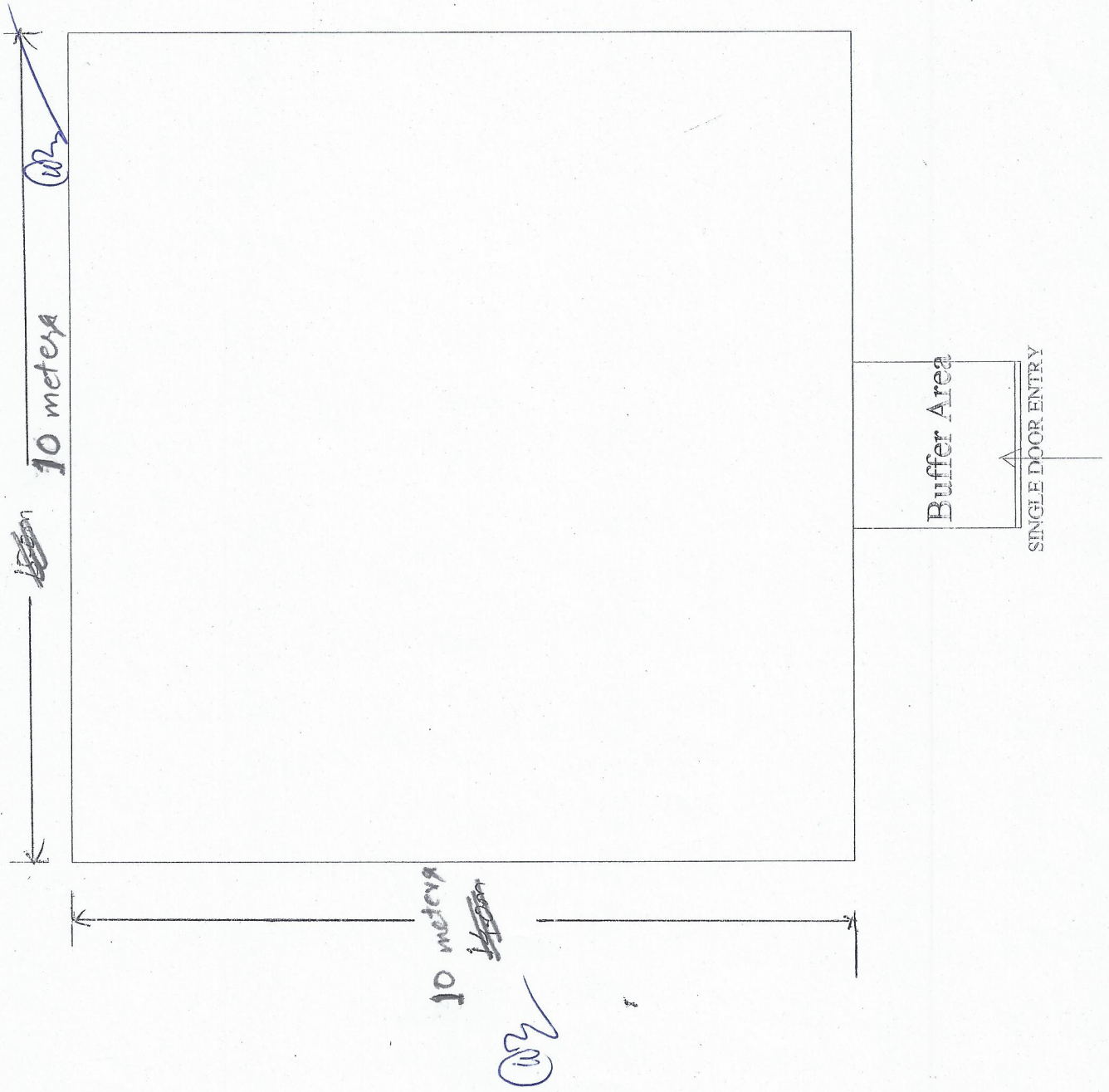

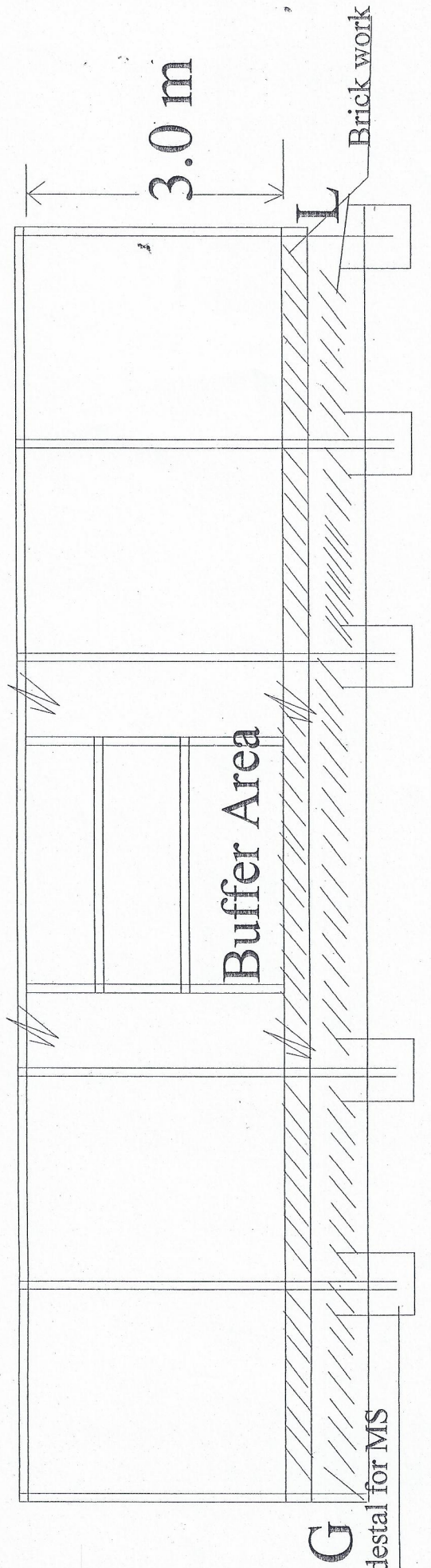

FRONT ELEVATION VIEW FROM THE BUFFER AREA SIDE WITH
SINGLE DOOR ENTRY